



Mould-ex SPECIALISED BATHROOM CLEANER

Mould-Ex easily dissolves grease and soap scale streaks. With its extra cleaning power **Mould-Ex** also whitens surfaces and fixtures in bath and toilet areas.

Application area: Effective for all enamel, stone, synthetic material and stainless steel surfaces.

- **Performance:** Whitens surfaces and fixtures in bath and toilet areas.
- **Efficiency:** High cleaning performance with bleaching effect.
- **Safety:** Product is directly dispensed from its ready-to-use bottle.



USE INSTRUCTIONS

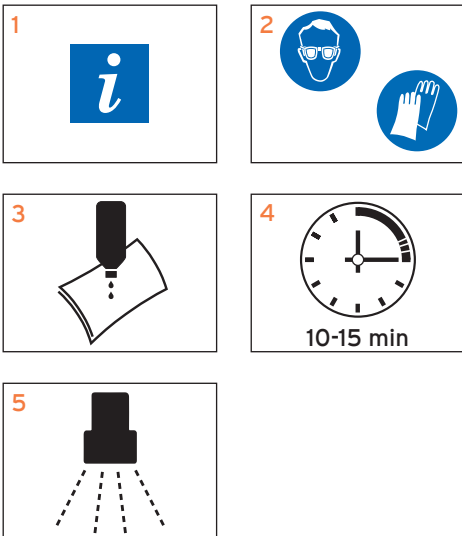

- 1 Check hygiene plan and product label for detailed use information.
- 2 Wear suitable protective clothing when handling the product.
- 3 Apply **Mould-Ex** to a wet cloth and wipe over black stains on grout. For resistant stains use a brush.
- 4 Allow **Mould-Ex** to act for some time (10-15 min).
- 5 Rinse with water.

SPECIAL NOTES / INFORMATION

Do not apply on non-ferrous metals (aluminium). Contains bleaching agents. Product discolours textiles.

Do not mix with acid!

For professional use only!

SAFETY

For further information and safety instructions, see product label and Safety Data Sheet.

STORAGE CONDITIONS

Store between 0 °C and 40 °C in original closed container only.

PACK SIZE

4 x 1 L